

ELECTRIC GUITARS

Pacifica 112J/Pacifica 112XJ

SERVICE MANUAL

WARNING : CHEMICAL CONTENT NOTICE!

The solder used in the production of this product contains LEAD. In addition, other electrical/ electronic and/or plastic (Where applicable) components may also contain traces of chemicals found by the California Health and Welfare Agency (and possibly other entities) to cause cancer and/or birth defects or other reproductive harm.

DO NOT PLACE SOLDER, ELECTRICAL/ELECTRONIC OR PLASTIC COMPONENTS IN YOUR MOUTH FOR ANY REASON WHAT SO EVER!

Avoid prolonged, unprotected contact between solder and your skin! When soldering, do not inhale solder fumes or expose eyes to solder/flux vapor!

If you come in contact with solder or components located inside the enclosure of this product, wash your hands before handling food.



Pacifica 112J

■ CONTENTS

OVERALL ASSEMBLY	2
CIRCUIT DIAGRAM	4
WIRING	4
SPECIFICATIONS	5

This document is printed on chlorine free (ECF) paper with soy ink.

OVERALL ASSEMBLY

E27 Bridge Assembly: Pacifica 112J/Vintage Type YS-11CW (QC165000)
Pacifica 112XJ/Vintage Type YS-11CB (QC168400)

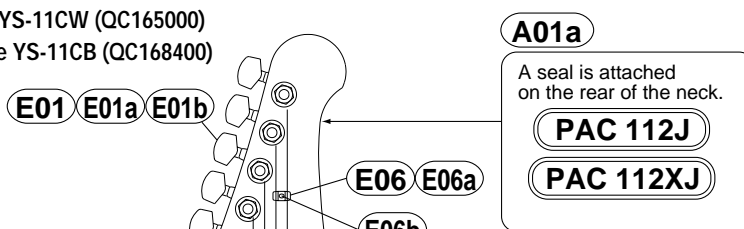
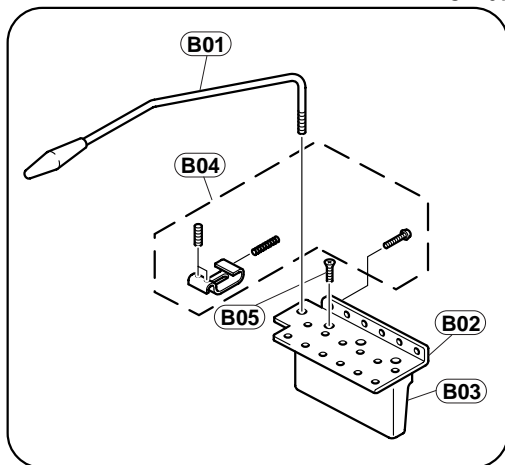

F11 Jack Installation

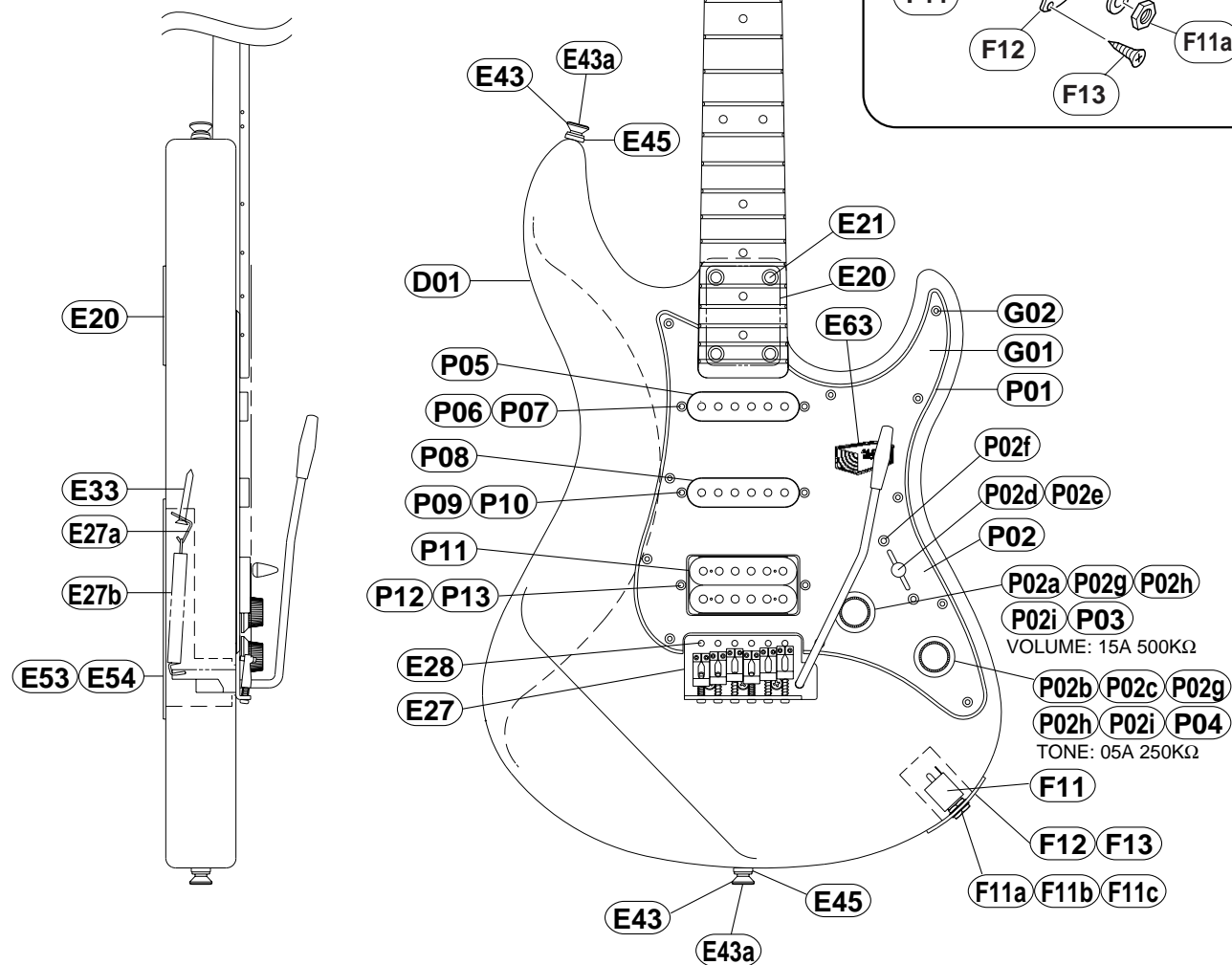
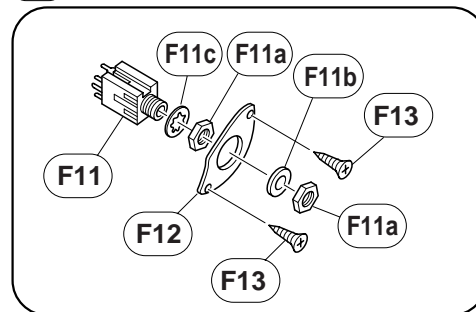

REF NO.	PART NO.	DESCRIPTION		REMARKS	QTY	RANK
* A01	AAX33260	OVERALL ASSEMBLY		Pacifica112J/112XJ		
* A01	AAX33270	Neck Assembly		Pacifica112J (NS)		
A01a	--	Neck Assembly		Pacifica112XJ (NS)		
A01a	--	Seal		Pacifica112J (QC67560)		
A01a	--	Seal		Pacifica112XJ (QC68950)		
D01	--	Body				
E01	QC164900	Tuning Machine Assembly	RM1273C (Chrome)	1set		12
E01a	--	Bushing				
E01b	--	Spacer				
E06	QC493700	String Guide	Vintage 2092SB	Chrome		01
E06a	--	Spacer				
E06b	--	Screw	1.8X10 (Chrome)			
E10	VD955900	Rod Cover	Black			01
E11	EB620070	Oval Head Wood Screw	2.1X10 FCM3BL	Black		
E12	VB344800	Nut	Urea 41mm (Black)			04
E20	QC015100	Neck Plate	Square (Chrome)			04
E21	EN240060	Oval Head Tapping Screw	4.0X45 FNM33G	Nickel	4	01
E27	QC165000	Bridge Assembly	Vintage YS-11CW	Pacifica112J (Chrome)		12
E27	QC168400	Bridge Assembly	Vintage YS-11CB	Pacifica112XJ (Chrome)		13
E27a	--	Arm Spring Plate				
E27b	--	Arm Spring		Pacifica112J	3	
E27b	--	Arm Spring		Pacifica112XJ	2	
E28	EA630100	Round Head Wood Screw	3.1X25 FCM33G	Chrome	6	
E33	EN240060	Oval Head Tapping Screw	4.0X45 FNM33G	Nickel	2	01
E39	--	Strings	D'Addario XL-120	1set (QC16510)		
E43	QC494000	Strap Button	ST-type (Chrome)		2	01
E43a	EN230140	Oval Head Tapping Screw	3.5X25 FCM33G	Chrome	2	04
E45	VB793700	Spacer	Felt (Black)		2	01
E53	CB822360	Back Cover	Bridge ST-type	Pacifica112J (White)		03
E53	CB822600	Back Cover	Bridge ST-type	Pacifica112XJ (Black)		04
E54	03706330	Oval Head Wood Screw	2.7X13 FCM33G	Pacifica112J (Chrome)	6	02
E54	EB620020	Oval Head Wood Screw	2.7X13 FCM3BL	Pacifica112XJ (Black)	6	03
E63	--	Sticker	ALDER BODY	(QC70930)		
F11	QC562600	Jack	KEJP6.3 MONO			03
F11a	LX200020	Hexagonal Nut	9S FCM33G (Chrome)		2	01
F11b	LX200010	Flat Washer	9S FCM33G (Chrome)			01
F11c	ET800180	Toothed Lock Washer	A9S FNM33G (Nickel)			01
F12	VB518300	Jack Panel	Black			05
F13	EB620020	Oval Head Wood Screw	2.7X13 FCM3BL	Black	2	03
G01	--	Pick Guard Assembly		Pacifica112J (QC67550)		
G01	--	Pick Guard Assembly		Pacifica112XJ (QC68980)		
G02	03706330	Oval Head Wood Screw	2.7X13 FCM33G	Chrome	11	02
H01	QC354000	Accessory Unit	G-1	1set		07
	--	Cord	2.5 BK			
	--	Wrench	#1.5	(QC58320)		
	--	Wrench	#5			
B01	QC165000	Bridge Assembly	Vintage YS-11CW	Pacifica112J (Chrome)		12
B01	QC168400	Bridge Assembly	Vintage YS-11CB	Pacifica112XJ (Chrome)		13
B01	AX811870	Arm	Chrome (Head:WH)	Pacifica112J		06
B01	AX805440	Arm	Chrome (Head:BL)	Pacifica112XJ		05
B02	AX814040	Bridge Base	Chrome			07
B03	AX814050	Bridge Tail				06
B04	AX814060	Bridge Piece Assembly	Nickel		6	05
B05	EX803070	Flat Head Screw	4.0X9 FCM33G	Chrome	3	01
	--	Pick Guard Assembly		Pacifica112J (QC67550)		
	--	Pick Guard Assembly		Pacifica112XJ (QC68980)		
* P01	QC561000	Pick Guard	KPF4D-2S1H (White)	Pacifica112J		15
* P01	QC689900	Pick Guard	1ply (Black)	Pacifica112XJ		
P02	--	Electrical Unit		(QC49430)		
P02a	HS120070	Variable Resistor	15A 500K ohm	VOLUME		03
P02b	HS120100	Variable Resistor	05A 250K ohm	TONE		03
P02c	QC562300	Mylar Capacitor	KELM2A473J 0.022uF			01
P02d	KA502000	Pickup Switch	5-Position Lever			08

*: New Parts

RANK: Japan only

NOTE: The parts list continues to the next page.

Pacifica 112J/Pacifica 112XJ

REF NO.	PART NO.	DESCRIPTION			REMARKS	QTY	RANK
P02e	CB807510	Knob	White		Pacifica112J		02
P02e	CB821810	Knob	Black		Pacifica112XJ (with PU SW)		02
P02f	QC562000	Oval Head Screw	3.0X8 FNM33G (Nickel)		with Pickup Switch	2	
P02g	--	Hexagonal Nut	M8 t=2		with Volume	4	
P02h	--	Flat Washer	8 t=0.5		with Volume	2	
P02i	--	Toothed Lock Washer	10 t=0.5		with Volume	2	
P03	QC562400	Volume Knob	KPK6D2S1H-B (White)		Pacifica112J		04
P03	QC587000	Volume Knob	ST-type (Black)		Pacifica112XJ		06
P04	QC562500	Tone Knob	KPK6D2S1H-A (White)		Pacifica112J		04
P04	QC587100	Tone Knob	ST-type (Black)		Pacifica112XJ		06
P05	QC561100	Pickup Assembly	S/C KEU9DE6000S (WH)		FRONT/Pacifica112J		11
P05	QC166900	Pickup Assembly	S/C Taiwanese (BL)		FRONT/Pacifica112XJ		09
P06	QC561200	Pickup Spring	5X7.5X18 A			2	
P07	QC561300	Oval Head Screw	3.0X25 FNM33G		Nickel	2	
P08	QC561400	Pickup Assembly	S/C KEU9DE6000N (WH)		CENTER/Pacifica112J		11
P08	QC163800	Pickup Assembly	S/C Taiwanese (BL)		CENTER/Pacifica112XJ		09
P09	QC561200	Pickup Spring	5X7.5X18 A			2	
P10	QC561300	Oval Head Screw	3.0X25 FNM33G		Nickel	2	
* P11	QC675400	Pickup Assembly	H/B 403H (White)		REAR/Pacifica112J		
P11	QC288700	Pickup Assembly	H/B Taiwanese (BL)		REAR/Pacifica112XJ		09
P12	QC561600	Pickup Spring	5X30 B			2	
P13	QC561700	Oval Head Screw	3.0X30 FNM33G		Nickel	2	

*: New Parts

RANK: Japan only

CIRCUIT DIAGRAM

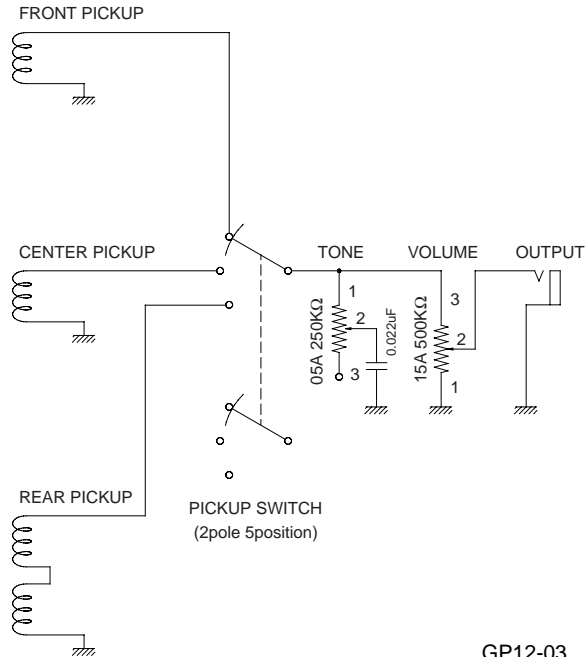

WIRING

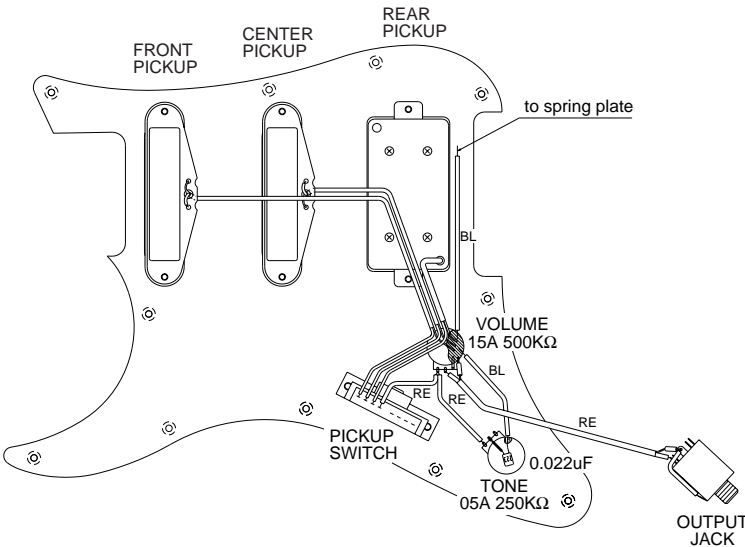

■ SPECIFICATIONS

● STANDARD SPECIFICATIONS

Scale Length	648.0mm
Body-Neck Construction	Bolt On
Length	978.5mm
Width	325.5mm
Net Weight	3.4kg

● COLOR

Body

Pacifica 112J	
YNS-O	Yellow Natural Satin-Open Pore
BL	Black
LPB	Lake Placid Blue
RM	Red Metallic
OVS	Old Violin Sunburst
TDG	Translucent Dark Green

Pacifica 112XJ

YNS-O	Yellow Natural Satin-Open Pore
-------------	--------------------------------

Neck

NS	Natural Satin
----------	---------------

● BODY

Material	Alder
Body Depth	44mm

● FINGERBOARD

Material	Sonokeling
Fingerboard Width	0-F 41.0mm, 12-F 51.4mm
No. of Frets	22

● NECK

Material	Maple
Neck Thickness	1-F 20.9mm, 12-F 22.9mm

● PARTS

Hardware	Chrome Plated
Nut	Urea

Bridge

Pacifica 112J	Vintage Type: YS-11CW (Chrome) (Arm Head: White)
Pacifica 112XJ	Vintage Type: YS-11CB (Chrome) (Arm Head: Black)

Strings	D'Addario: XL-120
---------------	-------------------

● CONTROLS

Volume	15A 500K Ω x 1
Tone	05A 250K Ω x 1
Pickup Switch	2 pole 5 position Lever Switch

● PICKUPS

Front/Center	Single Coil
Rear	Humbucking
Magnet	
Front/Center/Rear	Ceramics