

Includes Stratocaster Type 5-Way Switching
Seymour's suggested wiring:

1st position: Full-output bridge pickup

2nd position: Full-output bridge pickup with the neck pickup to cancel hum

3rd position: Neck pickup

4th position: Tapped-output bridge pickup with the neck pickup to cancel hum

5th position: Tapped-output bridge pickup

Tapped Tele, 5 Way Switch

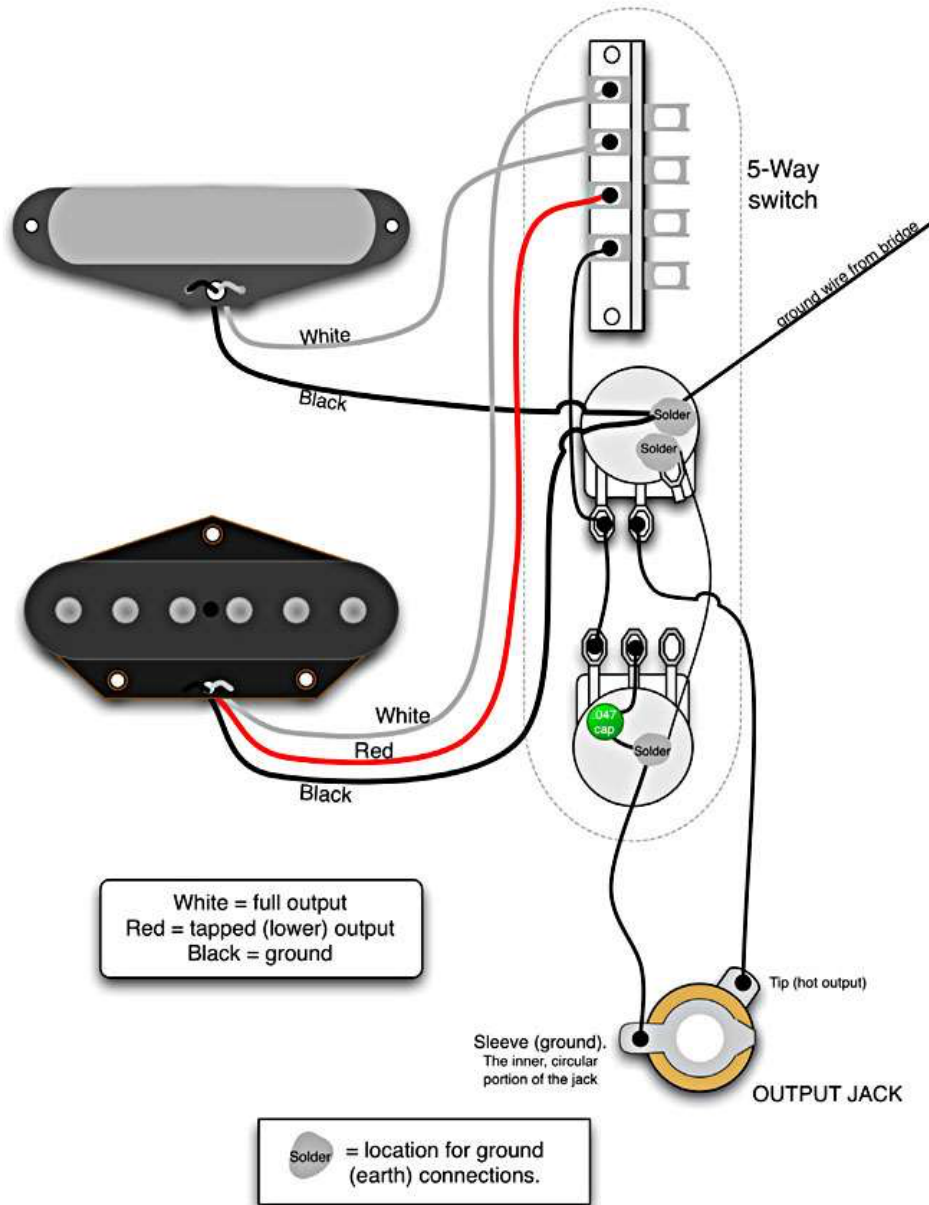

Copyright © 2006 Seymour Duncan/Basslines



**Seymour
Duncan®**

5427 Hollister Ave. • Santa Barbara, CA. 93111

Phone: 805.964.9610 • Fax: 805.964.9749 • Email: wiring@seymourduncan.com

THREE COOL ALTERNATE WIRING SCHEMES FOR TELECASTER®

post details

Posted on March 30, 2012 by admin

/post details



One of the great things about the Telecaster is the fact that there are so many cool alternate wiring schemes you can use. I want to tell you about three of my favorites.

BROADCASTER BLEND WIRING

The first one is the oldest one: the original Broadcaster wiring scheme with a blend knob.

Broadcaster with Blend

3-way switch settings

1. Bridge pickup with blend to allow neck pickup to be added.
2. Neck pickup alone (blend does nothing)
3. Neck pickup with .05 cap (very warm sound. blend does nothing)

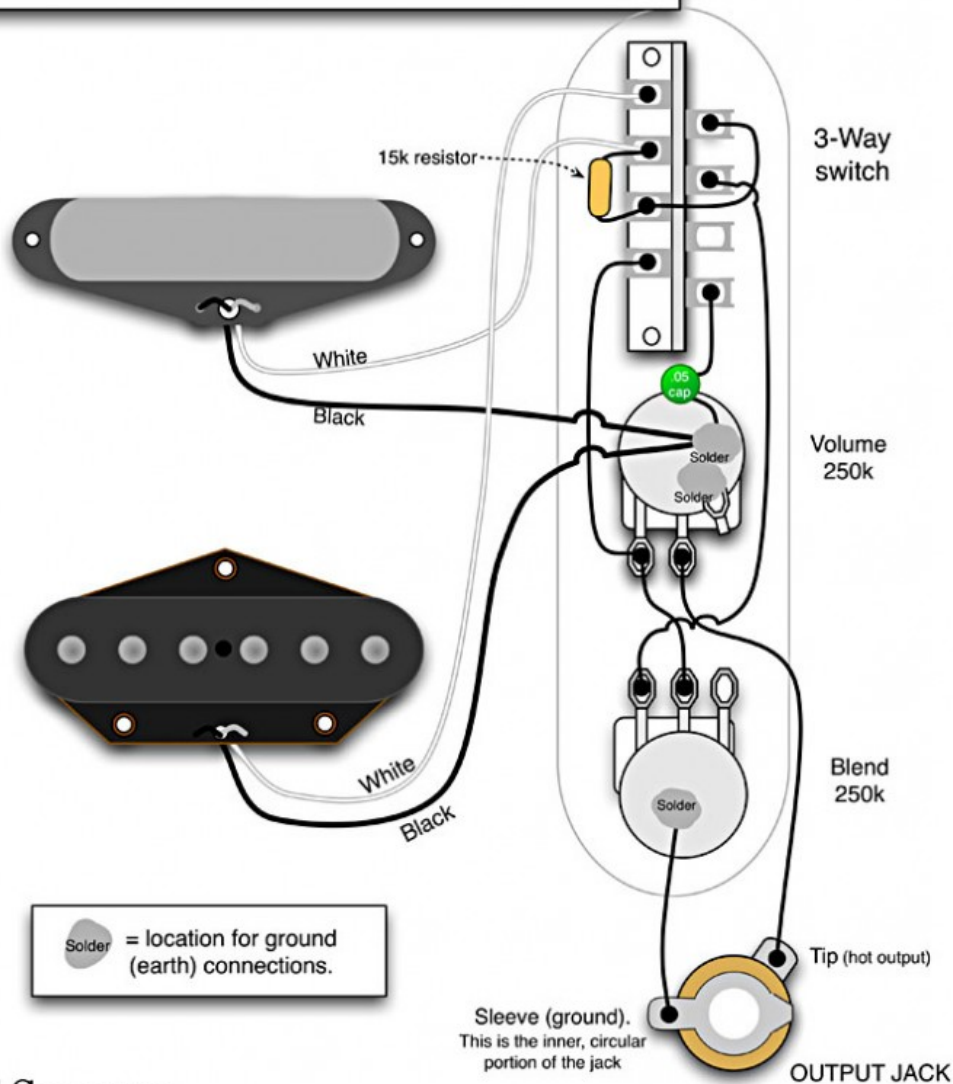

Copyright © 2006 Seymour Duncan/Basslines



**Seymour
Duncan**

5427 Hollister Ave. • Santa Barbara, CA. 93111

Phone: 805.964.9610 • Fax: 805.964.9749 • Email: wiring@seymourduncan.com

With this wiring, position 1 is the bridge pickup, position 2 is the neck pickup, and position 3 is a dark neck pickup tone with all the treble rolled off. That position 3 sound is too dark for a lot of players, though some guys like it for playing jazz or faking bass lines. But the coolest thing is, when you're in position 1, the tone knob acts as a blend switch,

and you can mix in as much or as little of the neck pickup as you like. There are some really nice blends in there that you can't get with the standard wiring scheme.

There's a trade-off, though: You don't have a regular tone control. So this is probably not a good choice for players who like using their tone knobs for wah-type sounds. But if you don't use your tone knob a lot, or just use it to take off a little top end when you're in the bridge position, you may find you get everything you need from the blended settings.

For a super-authentic tone, try this with my **Vintage Broadcaster Pickup Set**.

TAPPED TELE® WITH 5-WAY SWITCH

The next idea uses the **Tapped Tele** pickup I developed. I'd always wanted a Tele or Esquire pickup with two output levels: a lower-output vintage sound and a hotter sound with extra volume and sustain. I designed a version for Alan Dutton, Jeff Beck's road manager. Jeff heard and liked it, and he used it on his Guitar Shop album.

Tapped Tele, 5 Way Switch

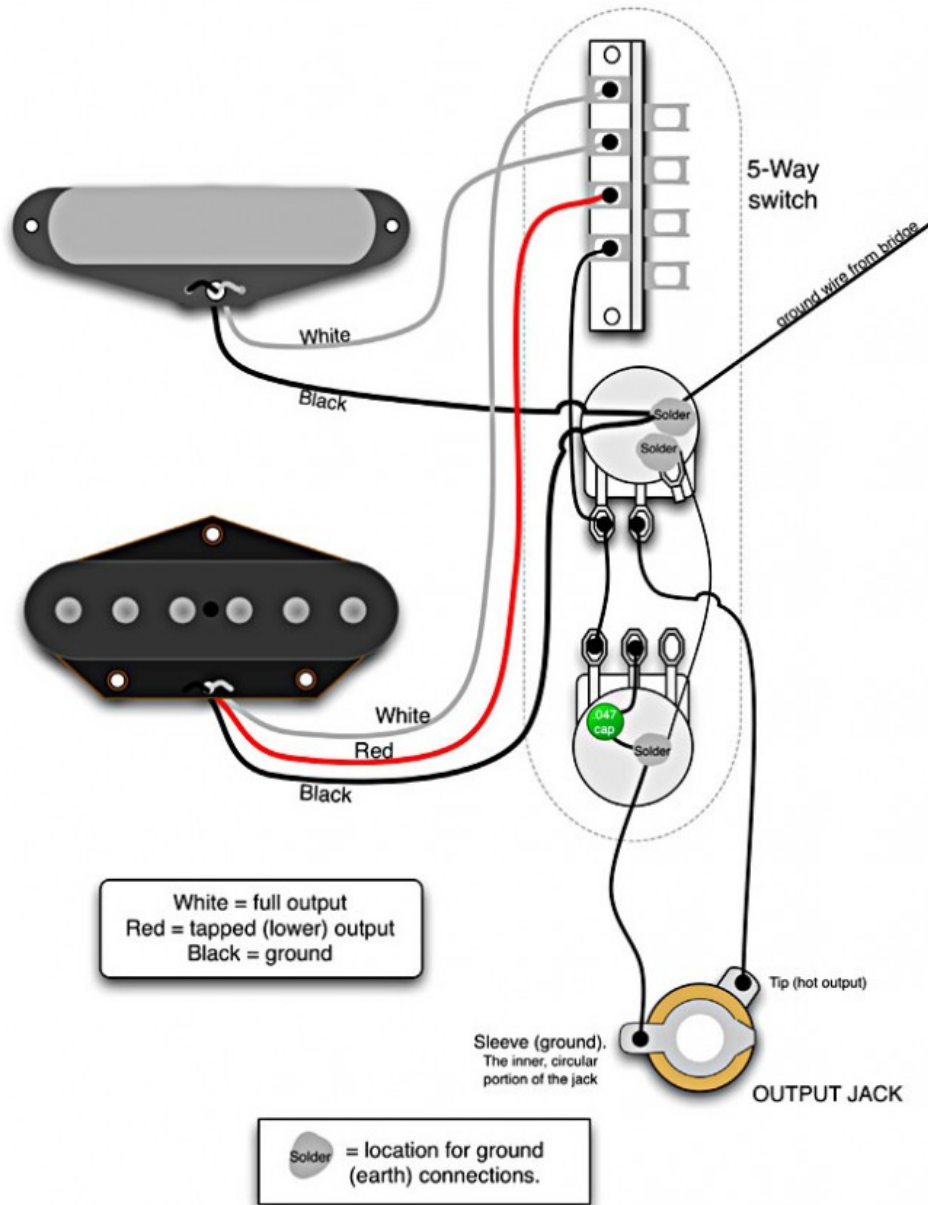

Copyright © 2006 Seymour Duncan/Basslines



**Seymour
Duncan**

5427 Hollister Ave. • Santa Barbara, CA. 93111

Phone: 805.964.9610 • Fax: 805.964.9749 • Email: wiring@seymourduncan.com

When you install this with a 5-way switch, you get the usual vintage Tele sounds in three of the positions. But in the other two, you get the beefier, full-output bridge pickup alone, and the full-output bridge pickup mixed with the neck pickup. I like this one because you get all the traditional sounds, plus two great higher-output settings.

We sell **Tapped Tele** pickups individually, and as part of

the Custom Shop '53 Tapped Tele Model T Guitar Shop Set, which includes a 5-way switch.

TELE WITH 4-WAY SWITCH

This is **another cool wiring scheme** that gives you all the traditional sounds plus something extra. The only special part you need is a 4-way switch.

Telecaster® with 4-Way Switch

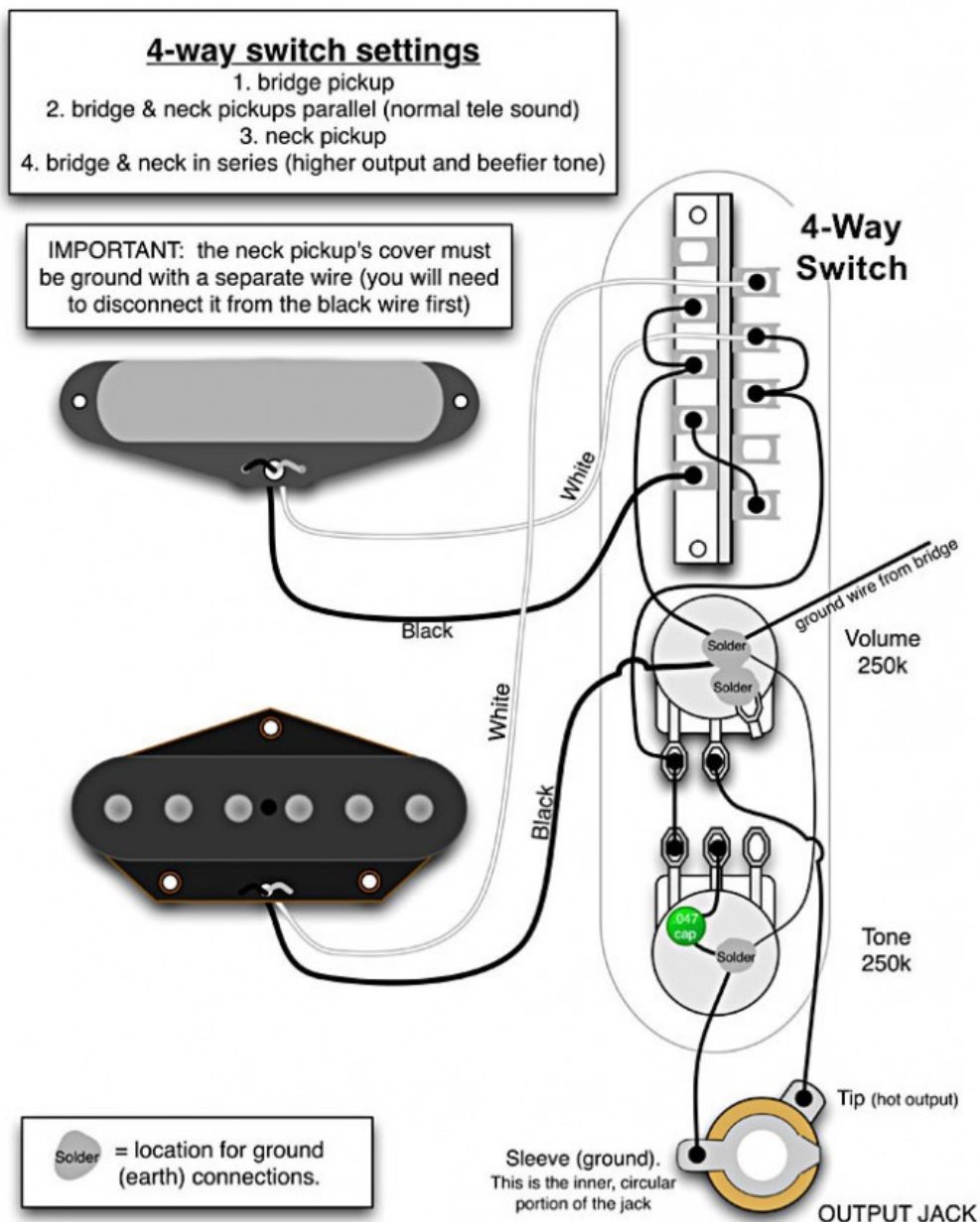

**Seymour
Duncan**

5427 Hollister Ave. • Santa Barbara, CA. 93111
Phone: 805.964.9610 • Fax: 805.964.9749 • Email: wiring@seymourduncan.com

This gives you the usual Tele sounds in the first three

positions. But in position 4, you get both pickups in series like a humbucker. It's a big boost in output and a big, fat tone.

But you need to make one important adjustment: The neck pickup's cover has to be grounded with a separate wire.

That means you have to flip the pickup over and cut the little un-insulated jumper wire that connects to the cover.

That leaves a 1/4-inch nub of wire connected to the cover.

Attach a new wire to that, and connect it to ground.

This wiring works great with any vintage-output Tele

pickups. It's also great with our **Five-Two® for Tele** pickups, which session players like Brent Mason and Dean Parks like because they provide great Tele twang, but with a slightly tighter, more focused low end.

Man, there are just so many great Telecaster wiring options. You can find even more of them at

seymourduncan.com/wiring.