



PO BOX 4394
SANTA ROSA, CA
95402 USA

P (707) 525-9941
F (707) 575-7046
EMGPICKUPS.COM



INSTALLATION INFORMATION EMG MODEL: ES-18 BATTERY POWER SUPPLY

GENERAL OPERATION

The ES-18 is an external 18 Volt battery supply for EMG Pickups. If you have an instrument that doesn't fit a battery, or you don't want to install a battery, the ES-18 is perfect for you. Using a stereo cable to bring +18 Volts via the Ring contact to the instrument, you can power your instrument easily. The ES-18 also has an external DC input for powering your guitar. See the notes on Page 2 about using an external DC supply. A standby switch also makes it convenient when changing instruments by shorting the input to the amplifier. In addition, the battery and external DC supply are protected by a resettable fuse in case the input/output are reversed.

SPECIFICATIONS:

Output Voltage Switch Selectble	+9 or +18 Volts
Maximum External Supply (Volts DC)	18 Volts
Maximum Current Drain (Fuse Reset)	50mA

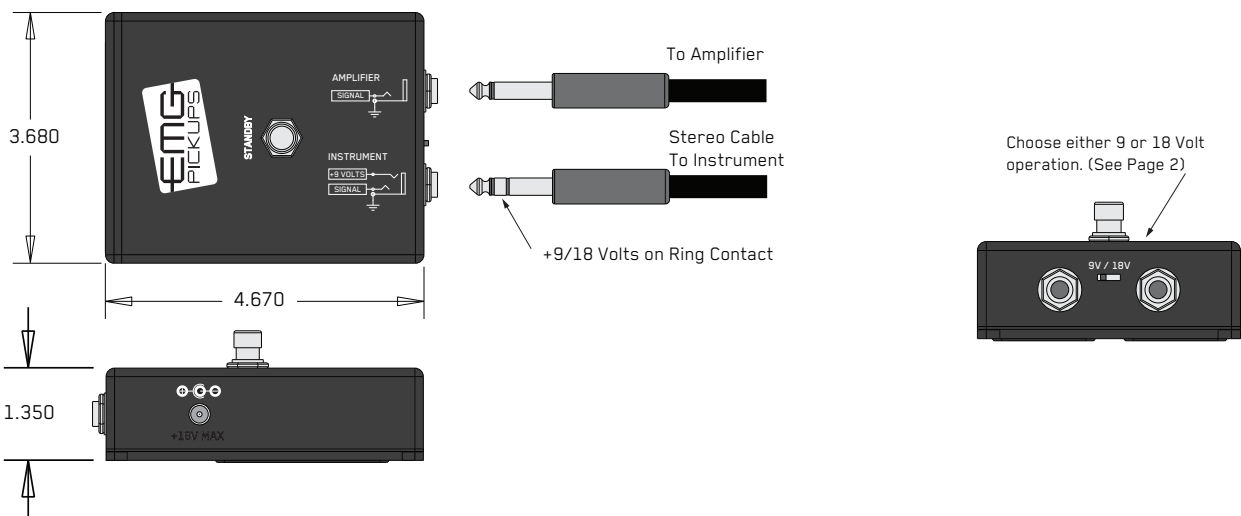

Battery Replacement

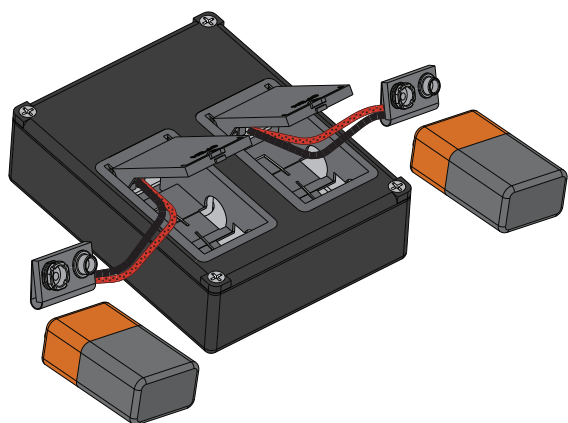

9-18 Volt Adapter (See notes about Adapters on Page 2)



Using an External DC Supply

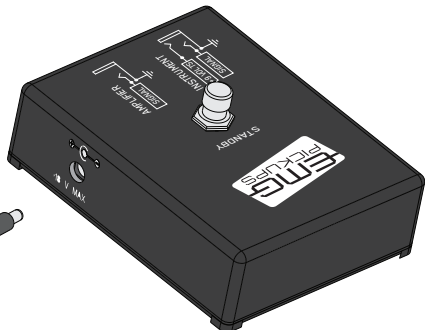

WHEN USING AN EXTERNAL DC SUPPLY
YOU DO NOT NEED TO REMOVE THE BATTERIES !

© 2016 Copyright EMG INC. All Rights Reserved.

New installations using the ES-18:

If you plan on using the ES-18 exclusively to power your instrument, follow the instructions that come with the pickups, install the battery buss and battery clips as shown in those instructions. Then install the shorting clips as shown below to use the ES-18. This way if you ever find yourself without a stereo cable you can still use your guitar with a mono cable. In that case simply unplug the shorting clips, install batteries, use a normal guitar cable, and you're ready to go.

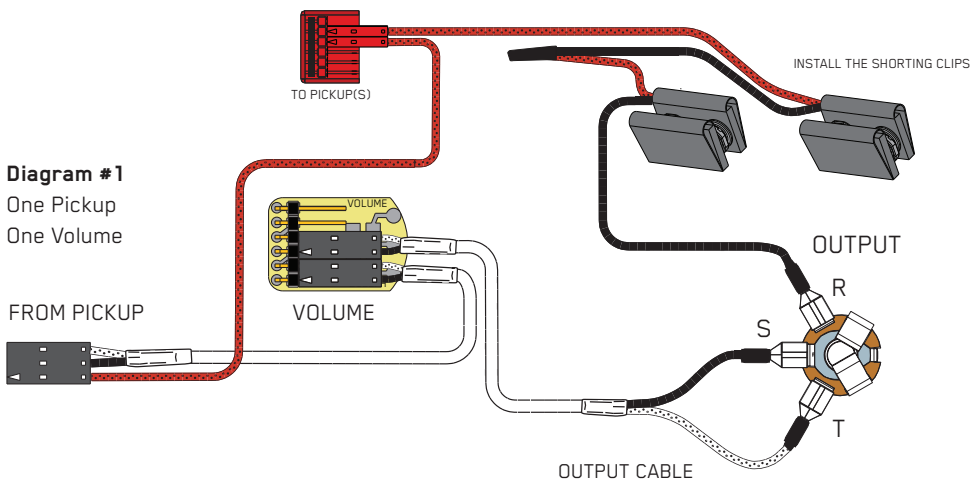

Existing EMG installations using the ES-18:

If you have one or more instruments with EMG Pickups installed, you can use the ES-18 for all of your guitars by installing a shorting clips onto the existing battery clips. Simply remove the existing batteries, install the included shorting clips and close up the instrument. You will be using the stereo cable to all your EMG equipped instruments from now on. If your stereo cable is broken, simply remove the shorting clips, re-install the batteries, and use a standard guitar cable like you used to.

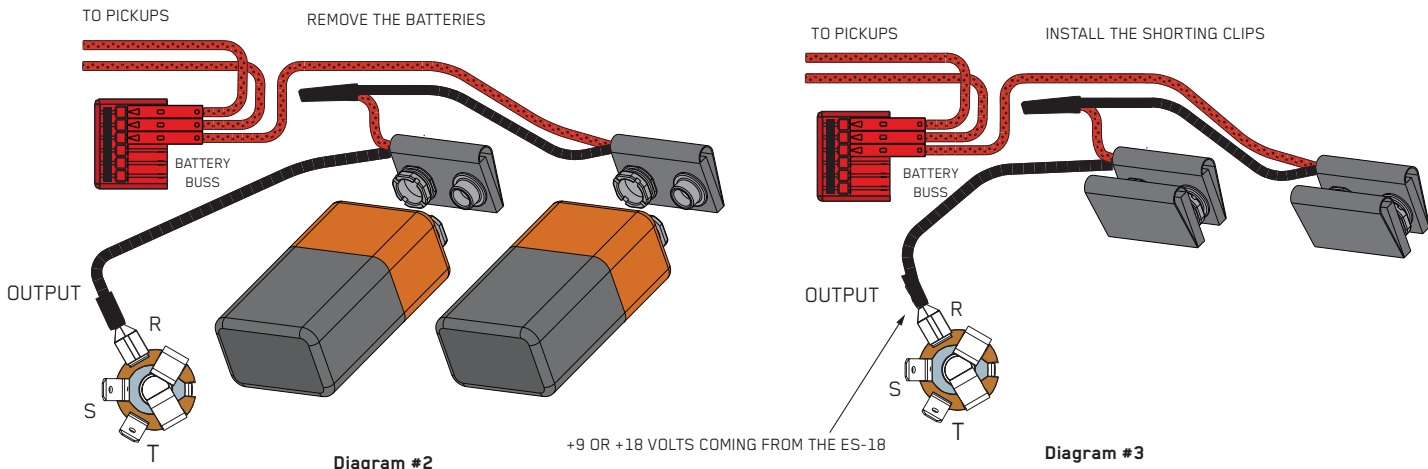

Battery Choice:

It is always best to use an Alkaline or Lithium Battery for EMG's. Re-chargeable batteries and inexpensive carbon batteries are not recommended. Alkaline and Lithium batteries are also easily recycled. A battery is the cleanest supply you can have and guarantees low noise.

Using an AC Adapter (Battery Eliminator):

Using an AC Adapter is not a great idea. They tend to be noisy. EMG has yet to spec or design an AC Adapter. Effects pedals tend to be noisy because they usually add a lot of gain. Since the pickup is the first element in the chain it's best for it to have as quiet a power supply as possible, thus a battery. If you can tolerate the extra noise from an adapter the choice is yours.

9 / 18 Volt Switch:

This switch allows you to supply your EMG's with either 9 or 18 Volts. 9 Volts is fine for single coil pickups, while 18 is preferred for Dual-Coil pickups as well as for Bass Pickups. THIS SWITCH IS ONLY OPERABLE WITH BATTERIES INSTALLED IN THE ES-18. If you use an external supply (AC Adapter) the switch is defeated and whatever voltage the AC Adapter is rated at will be the supply voltage to the pickups. Some guitar players prefer the sound of EMG's operating at 9 Volts. There is a compression that takes place and gives the pickup a louder more direct sound. Experiment.